

NMI Magic Seat Mark IV: User Instructions

To be operated by trained personnel only. Ensure maintenance is carried out at regular intervals.

Transforming seats to wheelchair user mode

1: Removing seat squabs and moving wall seat to the wall

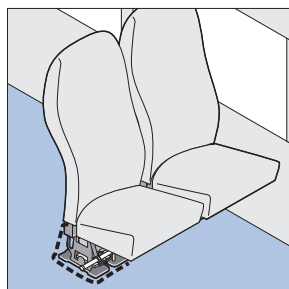

Remove seat leg covers by detaching spring clips

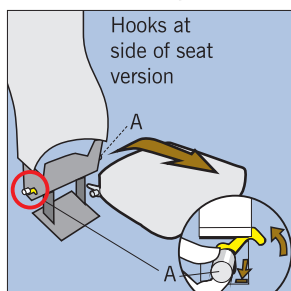

To remove the seat squab locate the release hooks. Both of these are either located on each side of the seat (*Left image*) or on some models at the back (*Right image*). Pull out plunger A from the hole on both sides of the seat and rotate hooks upwards and remove the seat squab and store. Repeat on other seat

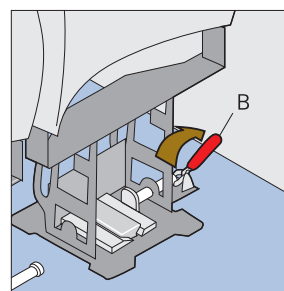
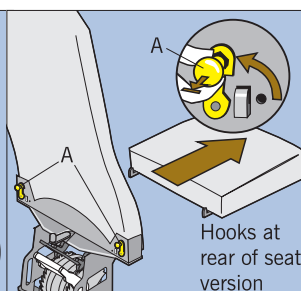

Unclamp wall seat by turning clamp handle B away from the seat

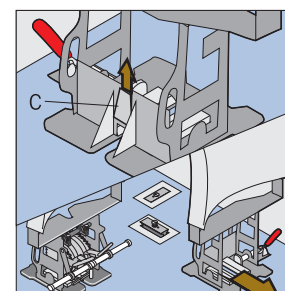

Lift the drop lock C at the back of the seat and slide the seat base forward off the floor pocket

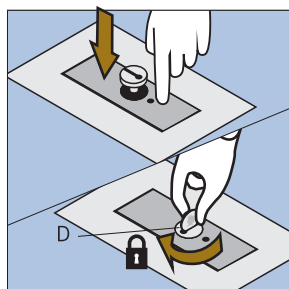

Push down the remaining floor pocket and lock in lower position by pushing in D and turning 90° away from the alignment of the dot

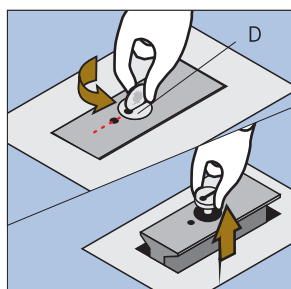

Raise the floor pocket nearest the wall by turning D to align with the dot and then pulling it up

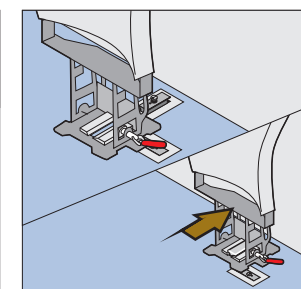

Slide wall seat base onto the raised floor pocket

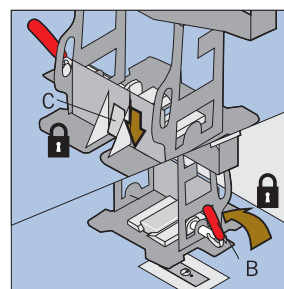

Lower drop lock C and clamp to lock by turning the clamp handle B towards the seat. The side seat is now in the side position

2: Positioning the aisle seat to wheelchair user location & preparing for the wheelchair user

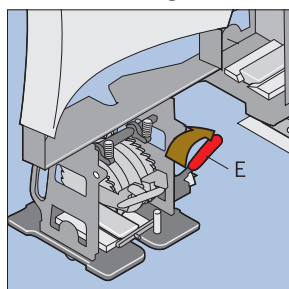

Unclamp wall seat by turning clamp handle E away from the seat

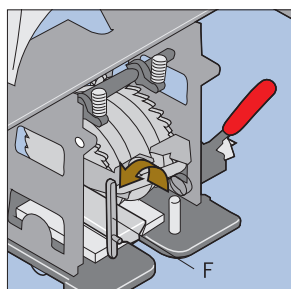

Lift up safety latch F

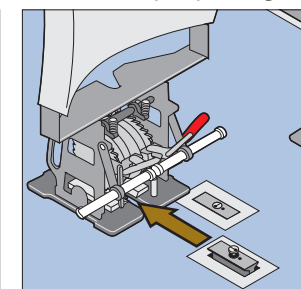

Slide the aisle seat back away from floor pocket

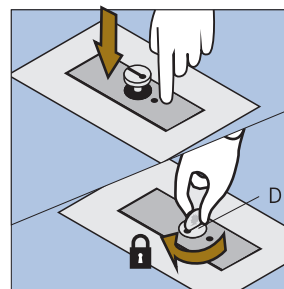

Push down the raised floor pocket and lock in lower position by pushing in and turning D 90° away from the alignment of the dot

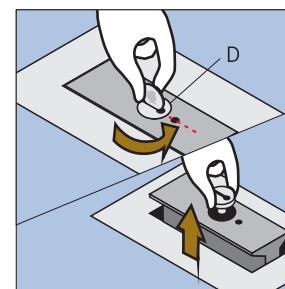

Raise the floor pocket closest to one you just closed by turning D to align with the dot and then pulling it up

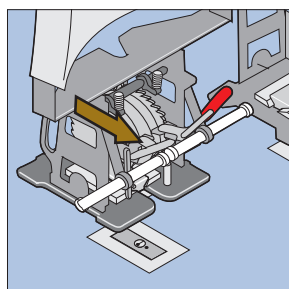

Slide the seat base onto the raised floor pocket

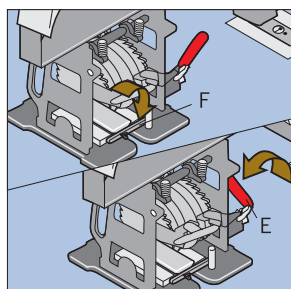

Drop safety latch F and clamp E by pointing the clamp handle towards the seat base

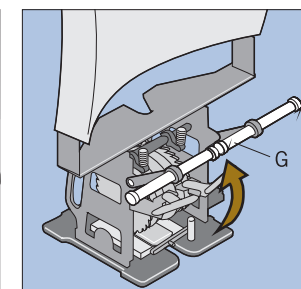

Lift up the two adaptor beams (G) to their highest position

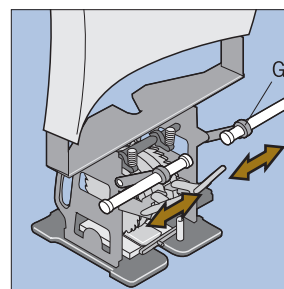

Align the 2 bars (G) to the rear of wheelchair frame by sliding them. These will later act as a support for the wheelchair frame to sit against

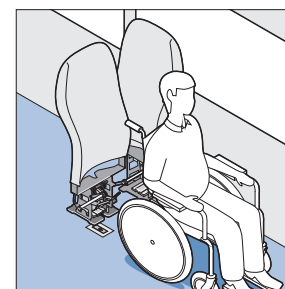

The wheelchair user can now locate in front of the seat.

Continued on next page...

...continued: Transforming seats to wheelchair user mode

3: Securing the wheelchair and wheelchair occupant

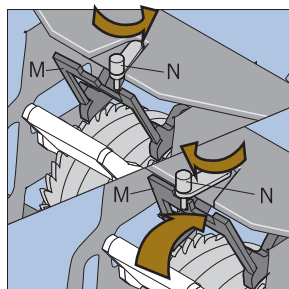

To release the webbing belts rotate safety catch N from back of M. Push M as far as it will go and rotate N so it holds M in the upper position

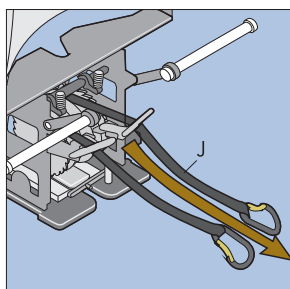

Pull webbing J out to fullest extent from the front of seat base

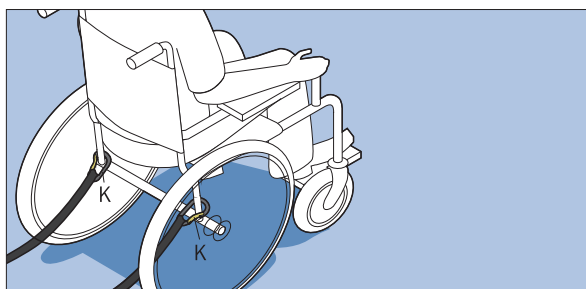

Attach the karabiners (K) to rear of the wheelchair frame as low down as possible on manufacturer's recommended securement points



Caution: Under no circumstances must the karabiners be attached to the front of the wheelchair frame.

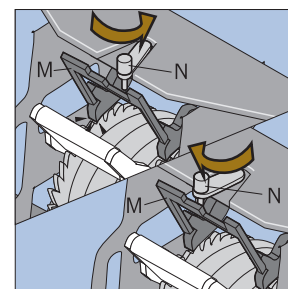

To engage the webbing drums rotate hook N away from dog arm M so M is released and the dogs engage with the ratchet drums. Then rotate safety catch N behind M.

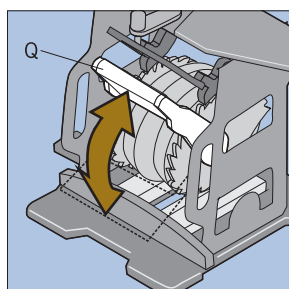

Pump foot pedal Q with foot to ratchet in the wheelchair until the wheelchair is secure
Note: Do not over tighten



Insert support cushion P if required

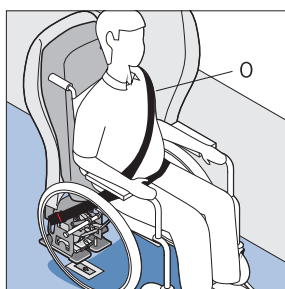

Now assist and apply the inertia belt O located on the seat back around the wheelchair passenger



Caution: Never travel with any forward/backward movement of the wheelchair.

Transforming seats from wheelchair user mode to coach seat mode

Releasing the wheelchair and instructions to get to coach seat mode

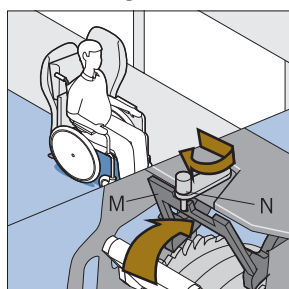

Assist the wheelchair user if necessary to remove their seatbelt. Remove any support cushion. To release the webbing belts rotate safety catch N from back of M. Push M as far as it will go and rotate N so it holds M in up position

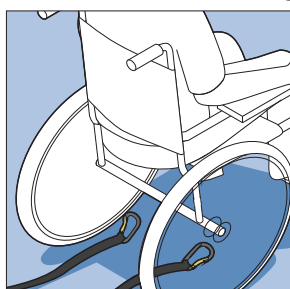

Release wheelchair brakes (+ switch on electric versions). Move the wheelchair forward to extend the webbing belt restraints. Put on the brakes (+ switch off power) and remove the webbing belt karabiners

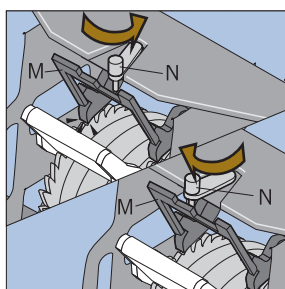

To engage the webbing drums rotate hook N away from dog arm M so M is released and the dogs engage with the ratchet drums. Then rotate safety catch N behind M.

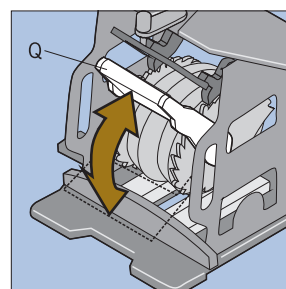

Pump the foot pedal Q to ratchet the webbing belts onto the webbing drums. **Do not over tighten**

The wheelchair user is now clear to leave the vehicle

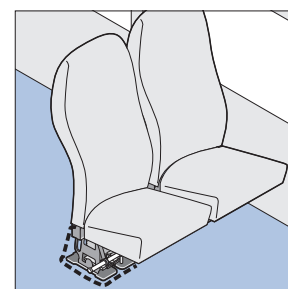

To arrange the seats to their four coach seat travel mode follow the instructions in reverse starting with the last image in stage 2 on the previous page doing the opposite in each step